

Owner's Manual

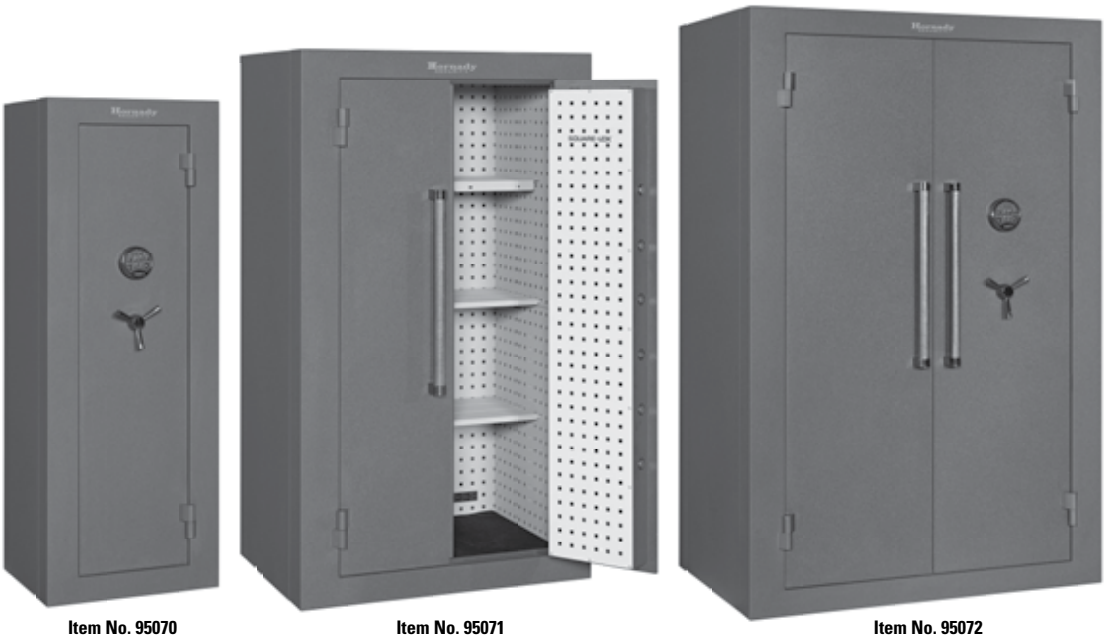

Mobilis™ Safes

Featuring
SQUARE-LOK™
Organizing System



Item No. 95070

Item No. 95071

Item No. 95072

Instructional videos for Hornady Security® products are available at hornady.com.



READ THIS FIRST

TIP OVER HAZARD: Serious or fatal injuries can occur from furniture tipping over. The Mobilis™ Safe must be securely fixed to the floor to prevent tipping and theft. Hardware for concrete floor is included and must be installed properly. Hardware for other floor types must be purchased separately and compatible with your particular floor construction. The Mobilis™ Safe includes mounting holes in the floor to aid in mounting to a floor.



Warning: NEVER store a loaded firearm in the Mobilis™ Safe under any circumstances. The risks associated with storage of a loaded firearm include, but are not limited to, unintentional discharge upon insertion or removal of the firearm. Unintentional discharge may result in bullet and safe fragments dispersing in multiple directions, which may cause serious injury or death. Hornady Security® is not liable for any misuse of this safe.

Warning: No safe is entirely secure. The Mobilis™ Safe is only as secure as your maintenance of the keys and code. You are solely responsible for maintaining your keys and code. Carefully read and understand all instructions supplied with your safe, including supplemental instructions from the lock manufacturer, to properly change and manage all codes. Keep your keys in a secure location at all times. Store your safe in a secure location away from your keys. Hornady Security® is not liable for unauthorized access, including damage to, or loss of property, or personal injury. Again, **NEVER** store a loaded firearm in your Mobilis™ Safe, as this may result in unauthorized access to the loaded firearm.

Warning: Except as expressly provided in the Hornady® Limited Warranty, Hornady Security® is not liable for any expense or damage associated with your inability to open the Mobilis™ Safe. Electronic systems may fail. Verify that the keys furnished operate the lock. Keep your keys in a secure location at all times.

Warning: Hornady Security® is not liable for any loss, theft, or damage to personal property. This Mobilis™ Safe is not intended to protect the contents from fire, water, humidity, or other environmental conditions. Do not, under any circumstances, return this safe with any personal property inside.

Important Information

- **For trouble-free operation of your Mobilis™ Safe, please read and understand all instructions before use.**
- **Questions? Call our tech line at 800-338-3220.**
- **Never store loaded firearms in the Mobilis™ Safe. Follow local laws for firearm storage.**

Thank you for purchasing a Hornady Security® Mobilis™ Safe. Please read and understand all instructions carefully before proceeding with installing and operating your safe and storing valuables inside. If you have any questions along the way please refer to the FAQ and videos at HornadySecurity.com or call us at 1-800-338-3220.

TABLE OF CONTENTS:

Warnings & Important Information	1	Square-Lok™ Product Installation	20
Specs	2	Care & Maintenance	26
Parts List, Exploded Views	3	Frequently Asked Questions	26
Unpacking	9	Warranty	28
Assembly	11	Product Registration and Service	28
Programming & Operation	16		

SPECIFICATIONS

Mobilis™ Safe Single Door

No.95070

Exterior: 22" W x 59" H x 18" D

Interior: 18" W x 53.5" H x 14.4" D

Door Opening: 13" W x 52" H

Assembled Weight: 412 lbs.

Mobilis™ Safe Double Door

No. 95071

Exterior: 34" W x 59" H x 25" D

Interior: 30" W x 53.5" H x 21.4" D

Door Opening: 24" W x 52" H

Assembled Weight: 705 lbs.

Mobilis™ Safe Double Door MAX

No. 95072

Exterior: 46" W x 71" H x 31" D

Interior: 42" W x 65.9" H x 27.5" D

Door Opening: 37" W x 64" H

Assembled Weight: 1027 lbs.

*Combine with other
Square-Lok™ accessories to
customize your space.*



hornadysecurity.com/squarelok



MOBILIS™ SAFE SINGLE DOOR – 95070

Parts List

Item No.	Description	Item No.	Qty.
0	Mobilis Accessory Box	770148	1
1	Skeleton Key Set (2 keys)	SKxxx	1
2	1/2" Drive Ratchet Wrench	770044	1
3	19mm Socket	770033	1
4	M12x1.75 Hex Nut	770032	40
5	M12 Washer	770149	40
6	Square-Lok Grommets and Screws	970029	8
7	Square-Lok Grommet Removal Tool	970030	1
8	M5x12 Pan Head Phillips Screws	770150	24
9	M5 Clip Nut	770151	—
10	Handle Spindle (Black Chrome)	770144	3
11	3/8" Concrete Anchor Bolts	95851	2
12	110V Power Cord (C13)	770203	1
13	Exterior Front Door Assembly MBS – 22x59	770152	1
14	Exterior Side Panel MBS – 12x59	770153	2
15	Exterior Back Panel MBS – 22x59	770154	1
16	Exterior Top Panel MBS – 18x12	770155	1
17	Exterior Bottom Panel MBS – 18x12	770156	1
18	FireShield Side MBS – 12x59	770157	—
19	FireShield Top/Bottom MBS – 18x12	770158	—
20	Interior Square-Lok Side Panel MBS – 14x27	770160	4
21	Interior Top Panel MBS – 19x14	770162	1
22	Interior Bottom Panel MBS – 18x14	770163	1
23	Floor Mat MBS – 18x15	770164	1
24	Shelf Mat MBS – 9x9	770165	4
25	Square-Lok 4-Gun Rack	95793	2
26	Square-Lok 6-Gun Rack	95794	1
27	Square-Lok Shelf – 9x9	95780	4

Exploded View

Single Door – 95070

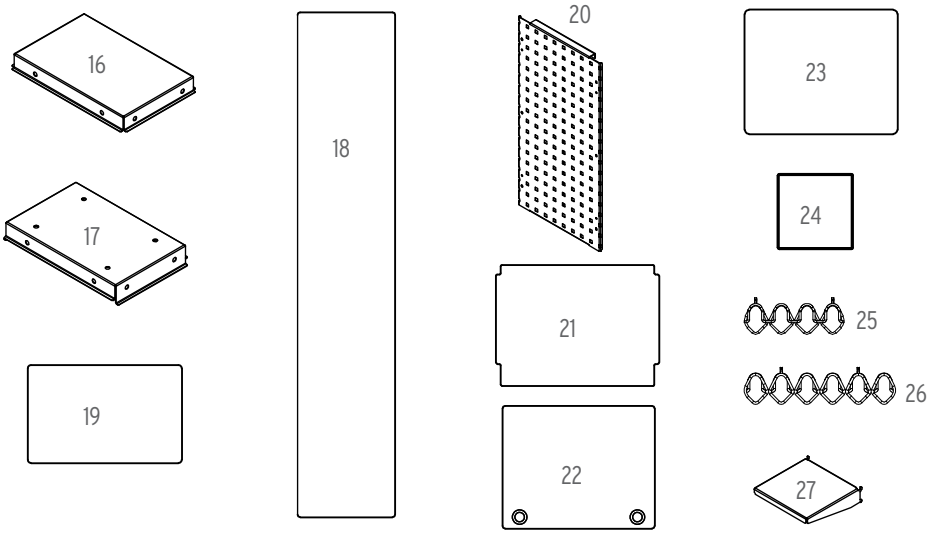
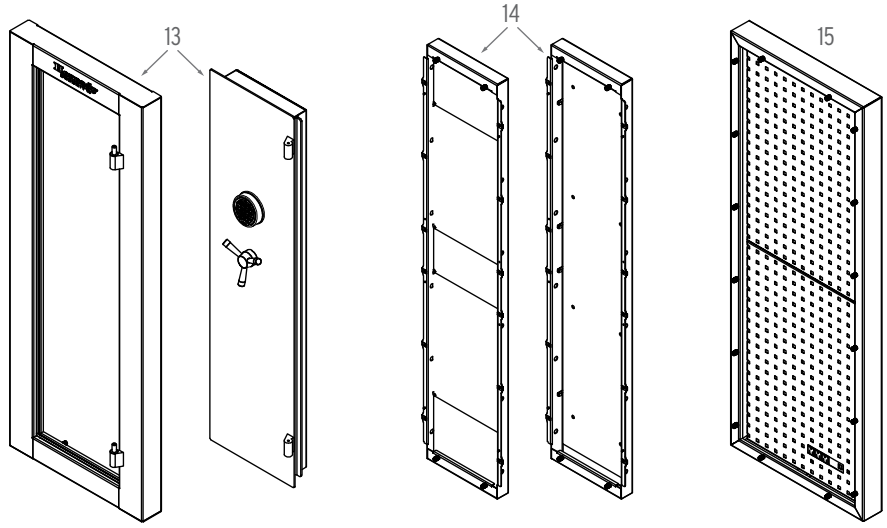
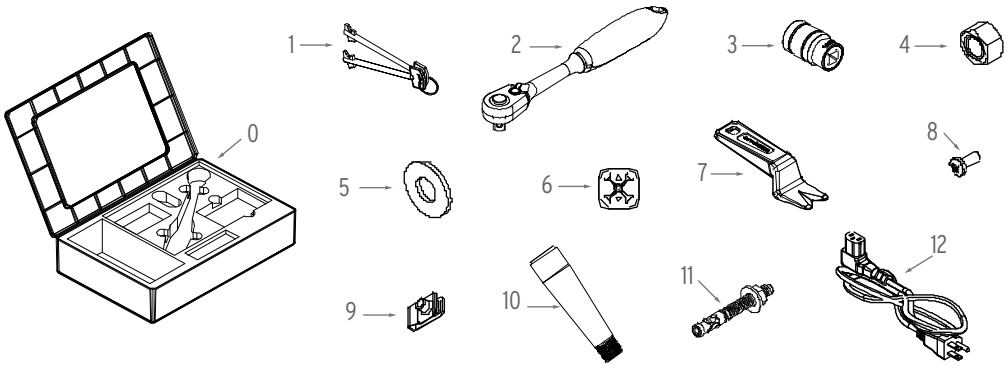

MOBILIS™ SAFE DOUBLE DOOR – 95071

Parts List

Item No.	Description	Item No.	Qty.
0	Mobilis Accessory Box	770148	1
1	Skeleton Key Set (2 keys)	SKxxx	1
2	1/2" Drive Ratchet Wrench	770044	1
3	19mm Socket	770033	1
4	M12x1.75 Hex Nut	770032	52
5	M12 Washer	770149	52
6	Square-Lok Grommets and Screws	970029	30
7	Square-Lok Grommet Removal Tool	970030	1
8	M5x12 Pan Head Phillips Screws	770150	24
9	M5 Clip Nut	770151	—
10	Handle Spindle (Black Chrome)	770144	3
11	3/8" Concrete Anchor Bolts	95851	4
12	110V Power Cord (C13)	770203	1
13	Exterior Side Panel MBD – 18x59	770168	2
14	Exterior Back Panel MBD – 34x59	770169	1
15	Exterior Top Panel MBD – 18x30	770170	1
16	Exterior Bottom Panel MBD – 18x30	770171	1
17	Exterior Front Door Assembly MBD – 34x59	770167	1
*	Frame	—	—
*	Left Door	—	—
*	Right Door	—	—
18	FireShield Side MBD – 18x59	770172	—
19	FireShield Top MBD – 18x30	770173	—
20	FireShield Bottom MBD – 18x30	770174	—
21	Interior Square-Lok Side Panel MBD – 20x27	770176	4
22	Interior Top Panel MBD – 31x22	770178	1
23	Interior Bottom Panel MBD – 30x21	770179	1
24	Floor Mat MBD – 30x21	770184	1
25	Shelf Mat MBD – 12x13	770185	3
26	Square-Lok 4-Gun Rack	95793	2
27	Square-Lok 6-Gun Rack	95794	2
28	Square-Lok Divider Wall MBD – 14x42	770180	1
29	Square-Lok Divider Cap MBD – 14x12	770181	1
30	Square-Lok Divider Support MBD/MBM	770182	1
31	Square-Lok Shelf Component MBD – 12x5	770183	6

Exploded View

Double Door – 95071

For parts 0 through 12, refer to page 4.

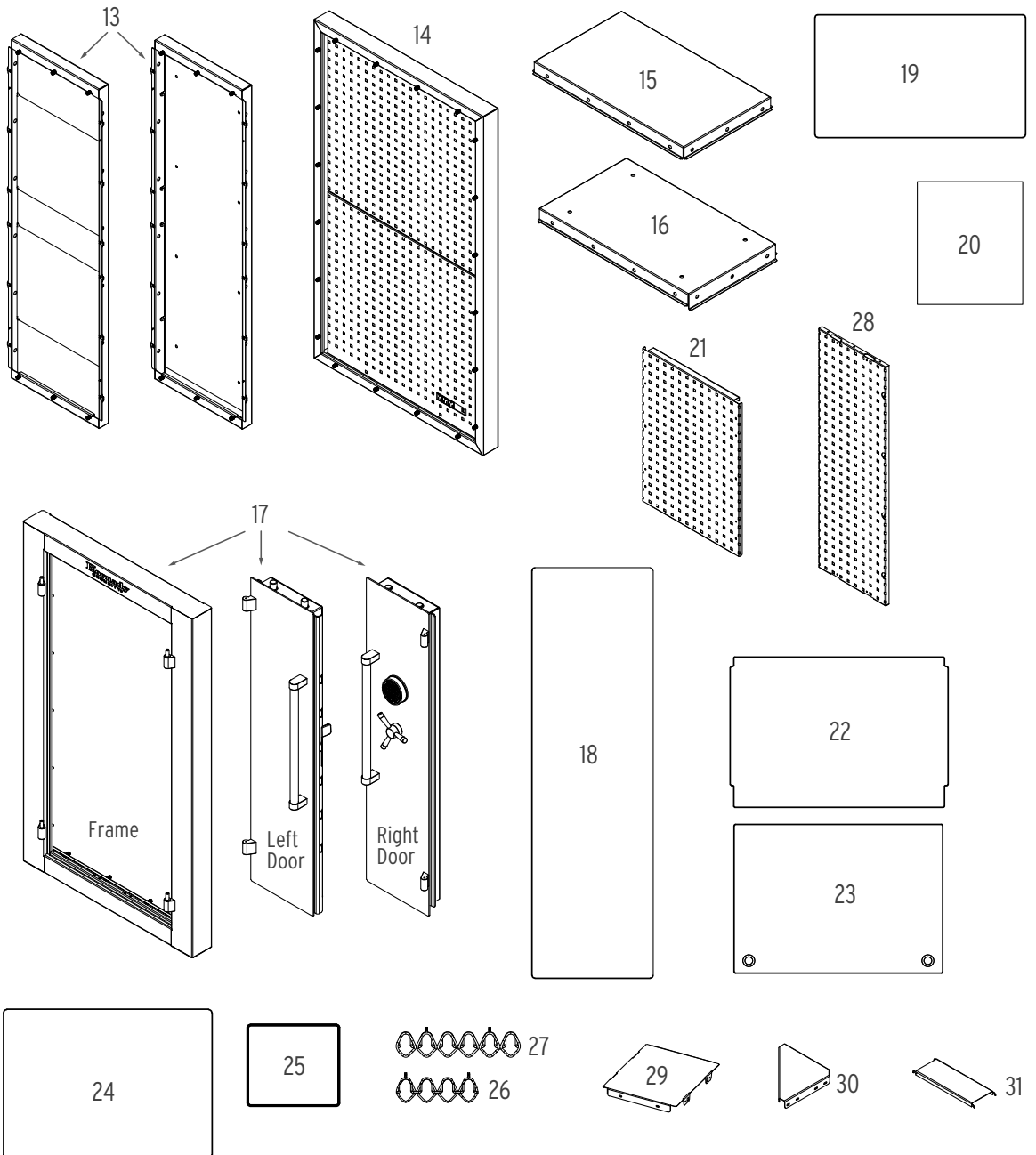

MOBILIS™ SAFE DOUBLE DOOR MAX – 95072

Parts List

Item No.	Description	Item No.	Qty.
*	Mobilis Accessory Box	770148	1
1	Skeleton Key Set (2 keys)	SKxxx	1
2	1/2" Drive Ratchet Wrench	770044	1
3	19mm Socket	770033	1
4	M12x1.75 Hex Nut	770032	60
5	M12 Washer	770149	60
6	Square-Lok Grommets and Screws	970029	35
7	Square-Lok Grommet Removal Tool	970030	1
8	M5x12 Pan Head Phillips Screws	770150	24
9	M5 Clip Nut	770151	—
10	Handle Spindle (Black Chrome)	770144	3
11	3/8" Concrete Anchor Bolts	95851	4
12	110V Power Cord (C13)	770203	1
13	Exterior Side Panel MBM – 24x71	770187	2
14	Exterior Back Panel MBM – 46x71	770188	1
15	Exterior Top Panel MBM – 24x42	770189	1
16	Exterior Bottom Panel MBM – 24x42	770190	1
17	Exterior Front Door Assembly MBM – 46x71	770186	1
*	Frame	—	—
*	Left Door	—	—
*	Right Door	—	—
18	FireShield Side MBM – 24x71	770191	—
19	FireShield Top MBM – 24x42	770192	—
20	FireShield Bottom MBM – 24x42	770193	—
21	Interior Square-Lok Side Panel MBM – 25x33	770195	4
22	Interior Top Panel MBM – 43x27	770197	1
23	Interior Bottom Panel MBM – 42x27	770198	1
24	Floor Mat MBM – 42x27	770204	1
25	Shelf Mat MBM – 18x18	770205	3
26	Square-Lok 4-Gun Rack	95793	4
27	Square-Lok 6-Gun Rack	95794	2
28	Square-Lok Divider Wall MBM – 18x42	770199	1
29	Square-Lok Divider Cap MBM – 18x18	770200	1
30	Square-Lok Divider Support MBD/MBM	770182	1
31	Square-Lok Shelf Component MBM – 18x5	770201	8

Exploded View

Double Door MAX – 95072

For parts 0 through 12, refer to page 4.

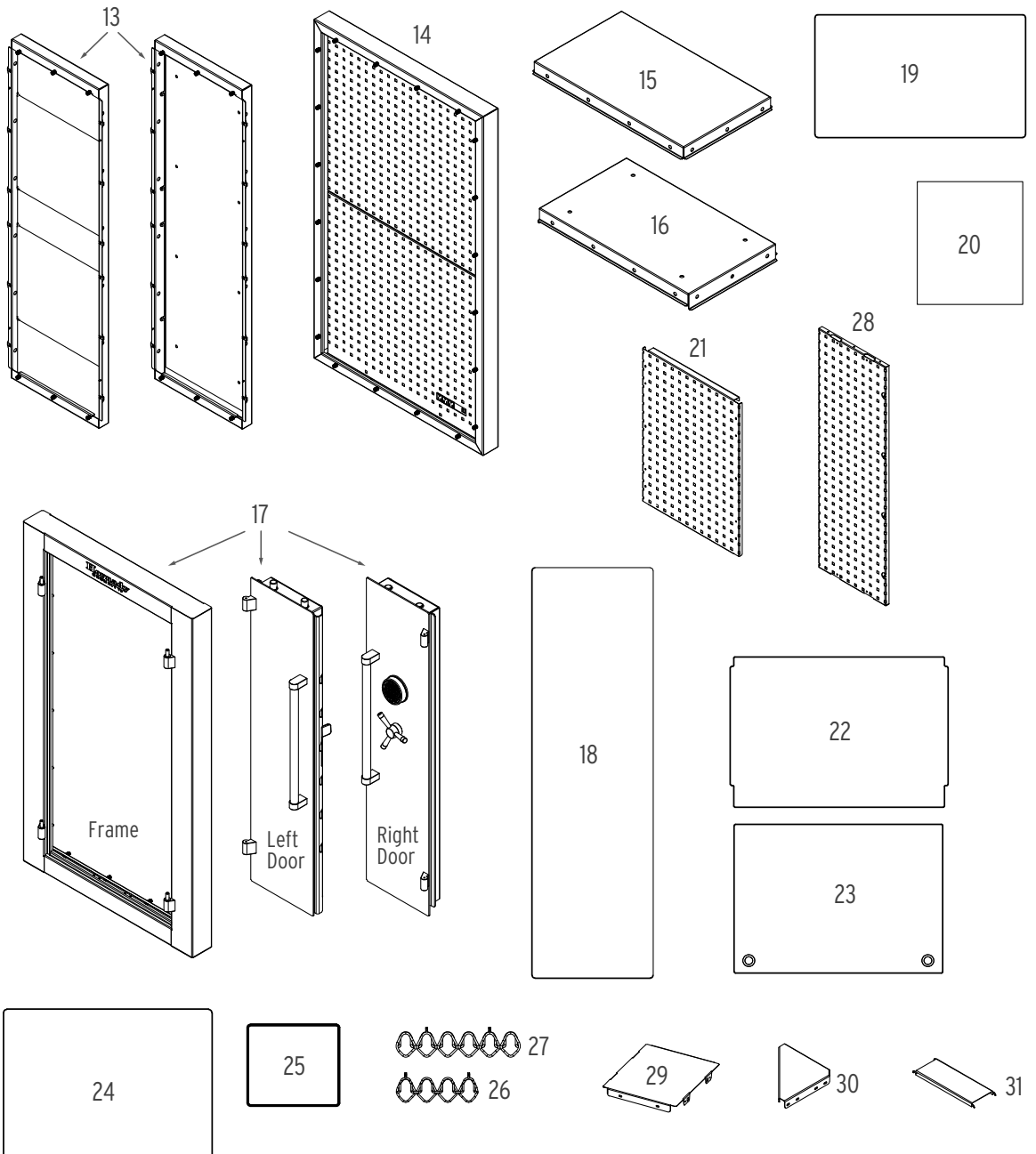

UNPACKING THE SAFE

- Tools Needed (not included) – Phillips screwdriver, 9V battery
- Although modular, some components of the safe are very heavy. Multiple people may be needed to safely lift and move components. Be careful not to pinch or crush fingers and toes.
- Place components in a safe location where they cannot tip or fall until needed for assembly.
- Be careful to protect painted surfaces while unpacking and during assembly.
- Each component is labeled to help identify and assemble. “FRONT” refers to the door side of the safe. “LEFT” and “RIGHT” are as you face the doors of the safe when assembled.

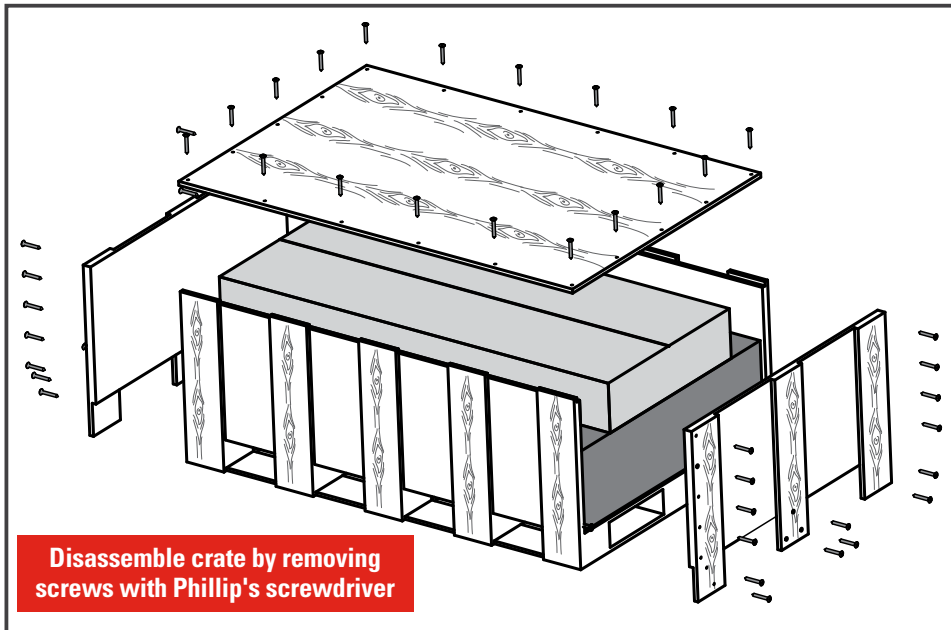

Step 1:

Remove screws from the top and end panels of the crate using a Phillips screwdriver.

Step 2:

Carefully remove components from crate and set aside until ready for assembly. The front door assembly can be left in the crate until ready for assembly.

Step 3:

Before unpacking the door assembly, the doors should be removed from the frame to lighten the weight and make the assembly process safer. To remove the doors, follow the steps below:

WARNING: The doors are very heavy and must be handled with caution. Removing the doors must be done very carefully to prevent damage to safe or to self. Be careful to not pinch fingers.

- A. Locate the handle spindles in the Accessory Kit. Thread each spindle into the center handle hub until finger tight.
- B. Place a 9V battery into the keypad (*see instructions on page 17*).
- C. Using the Phillips screwdriver, remove the screw on top of each hinge.
- D. When ready to remove the doors, enter the factory default code (1-2-3-4-5-6) and rotate the door handle clockwise until lugs retract.
- E. With the help of a friend, lift or open the door 90 degrees. To protect the frame, a scrap of foam or a cloth rag should be placed between the door and frame when removing the doors.
- F. To finish removing the door, carefully slide the door off the hinges while fully supporting the weight of the doors.
- G. The doors can be set aside until the final step of assembly.

Step 4:

The door frame can now be easily unpacked from the crate when needed

ASSEMBLING THE SAFE

- Tools Needed – 19mm socket and ratchet wrench (included) and Phillips screwdriver (not included)
- Although modular, some components of the safe are very heavy. Multiple people may be needed to safely lift and move components. Be careful not to pinch or crush fingers and toes.
- Place components in a safe location where they cannot tip or fall until needed for assembly.
- Be careful to protect painted surfaces while unpacking and during assembly.
- Each component is labeled to help identify and assemble. “FRONT” refers to the door side of the safe. “LEFT” and “RIGHT” are as you face the doors of the safe when assembled.
- The ceramic FireShield™ insulation can be removed to better access the nuts and bolts during assembly. Be careful not to rip or tear the blanket material.
- To assure the safe is assembled properly and square, it is best to build the safe on its back.
- To help align exterior panels, do not tighten the nuts until all exterior panels are fitted together. Once assembled, the nuts should be tightened snug, but excessive torque may damage the bolts.

Exterior Panels Assembly

Step 1:

To protect the safe and later help with standing up the safe, locate one of the large foam sheets used to ship the safe and lay on the floor where you intend to assemble the safe

Step 2a:

Locate the exterior back panel and lay on the foam sheet.

Step 2b:

For the Mobilis Double Door MAX safe, there are carry handles located on the back panel that must be removed before proceeding. To remove the handles use the 19mm socket and wrench to remove the nuts holding the handles.

NOTE: Saves handles in the accessory kit for future use.

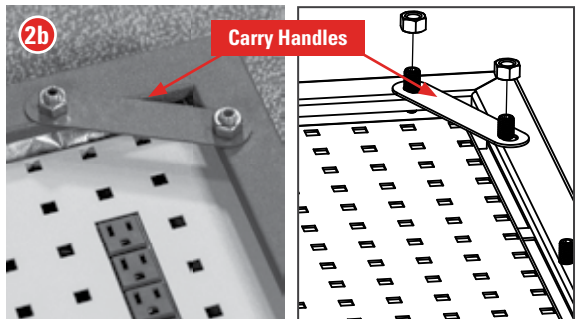
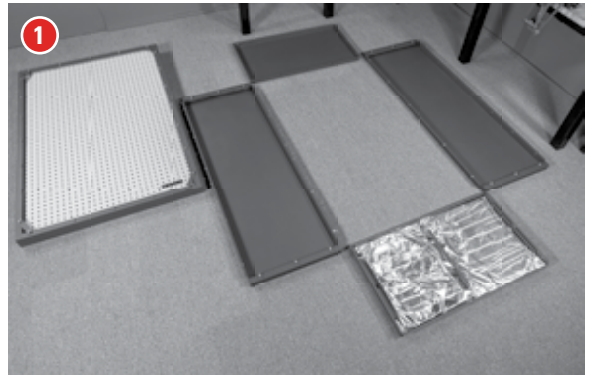

Step 3:

Locate the two exterior side panels, the top exterior panel, and the bottom exterior panel. Assemble the four panels together next to the back exterior panel as shown by inserting the bolts on the side exterior panels into the holes in the top and bottom exterior panels. Loosely place a washer and nut onto each bolt, but **DO NOT** fully tighten nuts until final assembly.

Step 4:

With the help of a friend, lift the side assemble onto the back exterior panel aligning the bolts on the back exterior panel with the holes in the side panel assembly. Loosely place a washer and nut onto each bolt, but **DO NOT** fully tighten nuts until final assembly. **DO NOT** stand on the interior of the back panel.

Step 5:

Locate the front door frame and place onto the partially assembled safe aligning the bolts on the front door frame with the holes in the side panels. Be careful not to pinch fingers between the components. Loosely place a washer and nut onto each bolt, but **DO NOT** fully tighten nuts until final assembly.

DO NOT stand on the interior of the back panel.

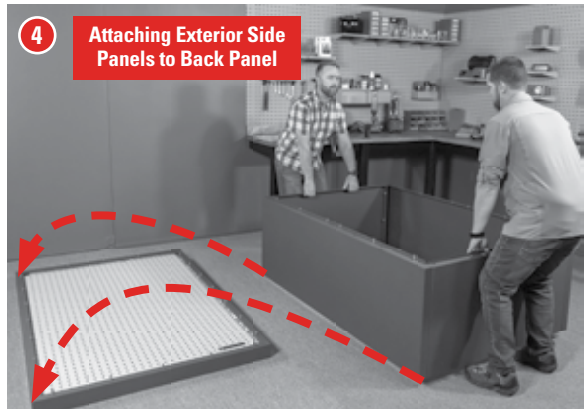

Step 6:

After the front panel has been placed squarely onto the side panels, tighten all nuts with the 19mm socket and wrench.

WARNING: Do not over tighten the nuts as it may damage the bolts.

Installing the Insulation and Square-Lok™ Interior Panels

Step 7:

After assembling the exterior panels, the FireShield™ blankets should be re-installed back into the exterior panels. Carefully tuck the blanket into the exterior panels and attach the elastic cord to hold the FireShield™ blankets in place. Confirm the FireShield™ blankets are not overlapping the flange of the exterior panels as this would cause issues installing the interior panels.

Step 8:

Install the top interior panel first by carefully placing inside the safe with the “BACK” arrow pointing toward the back of the safe. The top panel should be tilted into place with the front edge of the top interior panel inserted under the lip of the door frame first, then the back of the top interior panel should slid into place.

NOTE: If the top interior panel does not slide easily into place, remove and confirm the FireShield™ blankets are not interfering along the edges.

Step 9:

Install the interior side panels on each side of the top interior panel by placing an interior side panel inside the safe.

Note: Carefully handle painted panels to prevent scratching components.

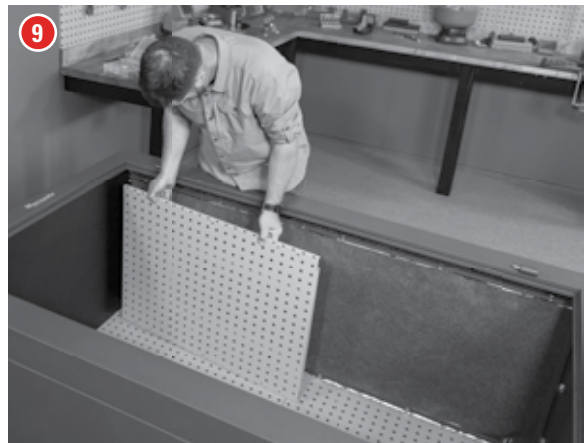

Align the pins in the exterior panels with the holes in the interior panels, then press the interior panels against the exterior panels. Attach the panels using a Phillips screwdriver and the included M5x12 Pan Head Phillips screws and washer.

Note: If the interior panels do not sit tight against the exterior panels, confirm the FireShield™ blankets are fully tucked into the exterior panels.

Step 10:

Repeat step 9 for the other 3 interior panels.

Step 11:

The bottom interior panel can be installed now or after tipping the safe upright and anchoring the safe into place.

To install the bottom panel insert the front edge into the door frame before sliding the back edge into place.

Step 12:

After installing the interior panels the safe can be tilted upright.

Before moving the safe to its intended location connect the power cord to the back of the safe.

WARNING: The partially assembled safe is very heavy. Please use adequate help to stand the safe upright and move into position.

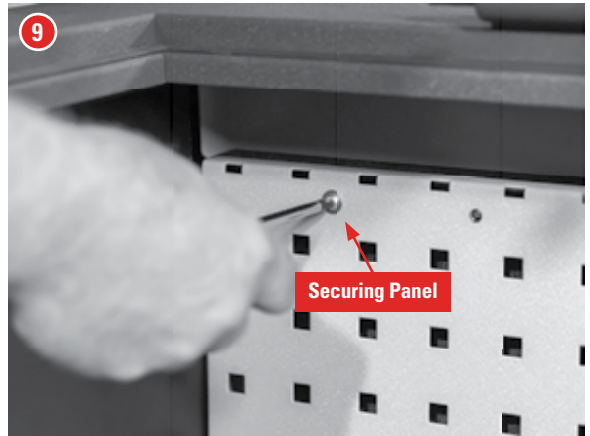

Connecting Power Supply

1. Plug the included 110V cable into the receptacle on the back of the safe (Fig. 1).
2. Plug other end into wall outlet.
3. Turn on power strip located inside the safe by flipping switch on power strip. Red light should come on when power is supplied to power strip (Fig. 2).

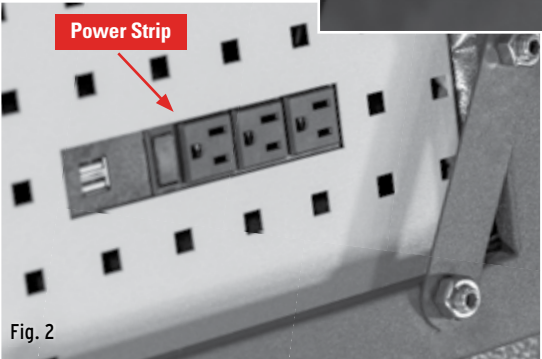
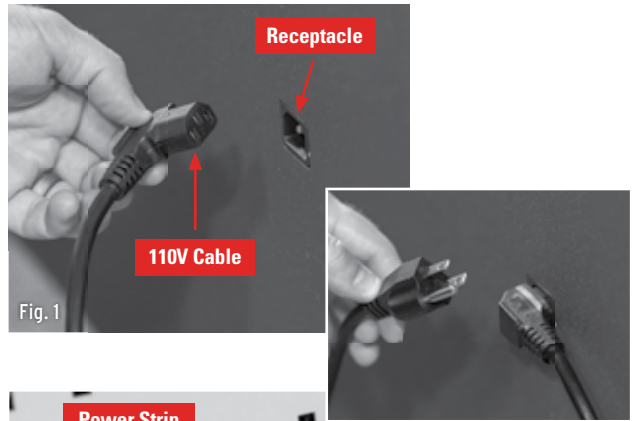

Installing Doors

WARNING: Before installing the doors, please carefully read all instructions. After installing the doors, become very comfortable with the operation of the safe before closing the doors or storing valuables inside.

With the safe positioned in its final location, the doors can be installed by simply sliding onto the hinge pins. Because of the weight of the door, it is helpful to have an assistant support the weight of the door while others align the hinge pins.

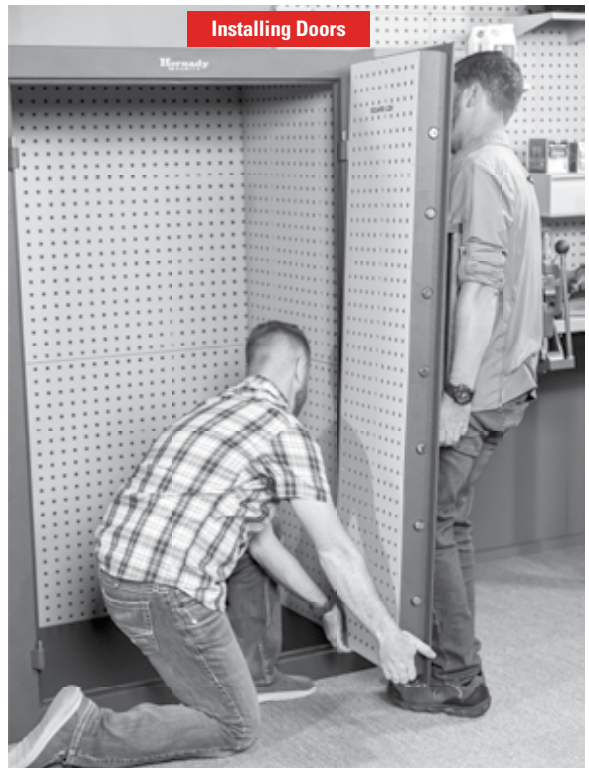

SAFE PROGRAMMING AND OPERATION

Carefully read and understand all instructions supplied with your safe, including supplemental instructions from the lock manufacturer, to properly change and manage all codes.

Opening and Closing Your Safe

Your factory preset combination code is 1-2-3-4-5-6. This code must be changed to prevent unauthorized access.

OPENING:

1. Enter the 6-digit combination code.
2. Rotate 3-spoke handle clockwise into the open position and pull door open.
3. The Entry Keypad re-locks in 4 seconds after a valid code has been entered.
4. The Entry Keypad will return to “standby” status with a long beep sound if there is no operation in 10 seconds after the system has been activated.
5. If you enter an incorrect combination 4-times in a row, the lock will shut down for 5-minutes.

Double Door Safes ONLY: To open the second door, push handle in door frame all the way down to unlock and swing door open.

CLOSING:

1. Close safe door.
2. Rotate 3-spoke handle counter-clock wise to the closed position until you hear bolts engage.

Double Door Safes ONLY: To close the left door, push handle in door frame all the way down and swing door closed. Lift handle all the way up to lock left door.



Double door handle down to unlock left door.



Double door handle up to lock left door.

Changing Your Combination Code

Carefully read and understand all instructions supplied with your safe, including supplemental instructions from the lock manufacturer, to properly change and manage all codes.

Your factory preset combination code is 1-2-3-4-5-6. This code must be changed to prevent unauthorized access. Write down and store a new 6-digit code. Do not store in safe.

You cannot set the combination code to six (6) zeros (0).

1. Open safe door and lock it in open position.
2. Enter zero (0) six (6) times. One beep sounds indicating the entry is valid and the system is awaiting a code change.
3. Enter the **existing** 6-digit code. One beep sounds, indicating the entry is valid.
4. Enter a new 6-digit code. One beep sounds, indicating the entry is valid.
5. **Re-enter** the new 6-digit code. One beep sounds, indicating that the code in steps 4 and 5 are the same and the code change is successful.
6. If three beeps sound, the code change was unsuccessful, and the existing code is still valid. Repeat steps 2 – 5.
7. Enter and check new code three times before closing door. **Store this combination in a location other than your safe.**

NOTE: Each step in the code change process must be completed in 10 seconds or the system reverts back to “standby” status.

Low Battery Alert

Your lock has a “Low Battery Alert.” If the Entry Keypad beeps repeatedly during an unlocking, the battery is low and needs immediate replacement.

Installing and Replacing Entry Keypad Battery

Your safe is equipped with an electronic lock made with non-volatile memory, meaning your combination code is retained even if the batteries are no longer powering the lock. If this happens, simply replace the batteries.

Install one high-quality 9V alkaline battery in the compartment in the bottom of the entry keypad. To replace the battery, follow these steps:

1. Release the latch of the battery compartment (Fig. 1).

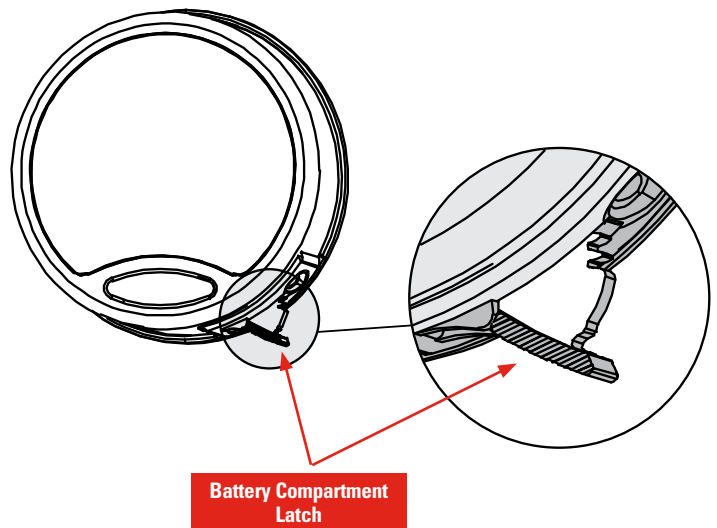

2. Pull out the battery compartment from the bottom of the entry keypad. Remove the battery and replace with a new 9V battery. Make sure to align the positive and negative poles as indicated.
3. Put the battery compartment back into the keypad and close the latch.

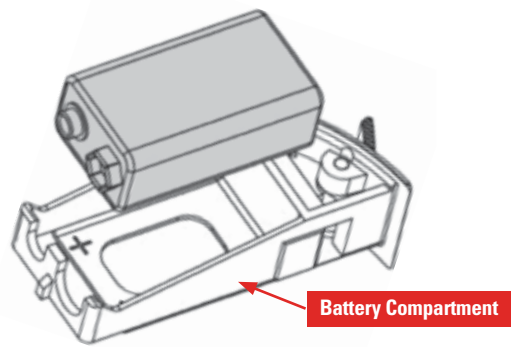

Backup Mechanical Key Override

WARNING: Store keys in a secure location away from the safe.

To access key override slot, gently slide digital keypad up and away from door to remove (Fig. 1).

NOTE: When digital keypad is removed, handle keypad and cable carefully to prevent damage to cable (Fig. 2).

Unlock:

Place key into slot as shown and rotate clockwise. With key rotated, rotate door handle clockwise to retract locking lugs and open door.

Lock:

Fully close door. Then rotate door handle counterclockwise to extend locking lugs. Rotate key counterclockwise to lock extended lugs and safe. Remove key and carefully tuck cable back into hole in door while replacing digital keypad. Make sure safe is locked.

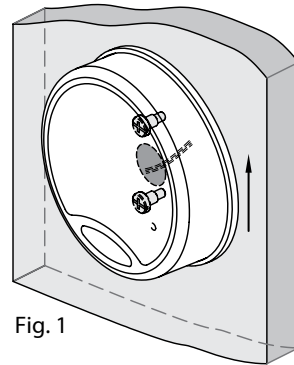
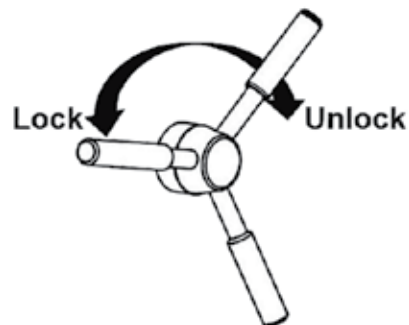
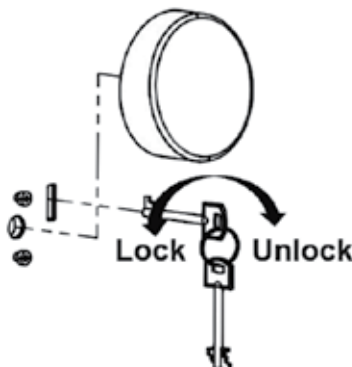

Fig. 1



Fig. 2



ANCHORING SAFE TO CONCRETE FLOORS:

Tools Needed (not included):

- Hammer
- 9/16" Socket
- Ratchet Wrench
- Hammer Drill
- 3/8" Concrete Drill Bit

Anchoring Instructions:

- Place the safe in the desired location.
- Remove the bottom interior panel of the safe by lifting up from the back.
- Remove the FireShield™ blankets to access the mounting holes in the bottom exterior panel.
- Use a minimum of two anchor bolts to secure your safe.
- Use hammer drill and a 3/8" concrete bit to drill each hole at least 3" deep into the concrete floor.
- Insert the anchor bolts through the safe floor and into the drilled holes. A hammer may be needed to tap the anchor bolts into the holes.
- Tighten the nuts using a 9/16" socket until the anchors expand snugly into place.
- Replace FireShield™ blankets and bottom interior panel.

NOTE: For anchoring to floors other than concrete, please consult with a professional contractor and use appropriate hardware.

INSTALLING SQUARE-LOK™ SHELVES AND ACCESSORIES

WARNING!

Improper installation or failure to properly secure Square-Lok™ Shelves to Square-Lok™ Panels may result in personal injury or property damage. Always secure Square-Lok™ Shelves to Square-Lok™ Panels in accordance with product instructions. Hornady® is not responsible for damage or injury resulting from improper installation or failure to properly secure Square-Lok™ Shelves.

The Square-Lok™ interiors of the Mobilis™ safes allow full adaptability and versatility in configuring your safe for your particular needs. Included with each safe are shelves and gun racks, but additional Square-Lok accessories can be found at hornadysecurity.com/squarelok.

Installing Square-Lok™ Nut Grommets

Square-Lok™ nut grommets are included with some Square-Lok™ accessories. They are designed to anchor the Square-Lok accessory to the Square-Lok™ panels to prevent accidental dislodging of the accessory. While the Square-Lok™ nut grommets “lock” the accessory into the Square-Lok™ panels, they can be easily removed and repositioned without causing damage to the Square-Lok™ panels.

NOTE: Square-Lok™ nut grommets should be used with all Square-Lok™ shelves and bins.

Installation:

To install the nut grommet, simply align the nut grommet with a hole in the back of the Square-Lok™ accessory and snap into the corresponding Square-Lok™ hole. Then install the Square-Lok™ accessory onto the Square-Lok™ panel and insert the screw and tighten.

Removal:

Remove screw and then the Square-Lok™ accessory. Use the Square-Lok™ nut grommet removal tool to remove nut grommet from Square-Lok™ panel. Insert nut grommet removal tool at a 45° angle between the Square-Lok™ panel and the flange of the nut grommet. Press the tool toward the center of the nut grommet to compress the tabs, then twist slightly to pop the nut grommet out of the panel.

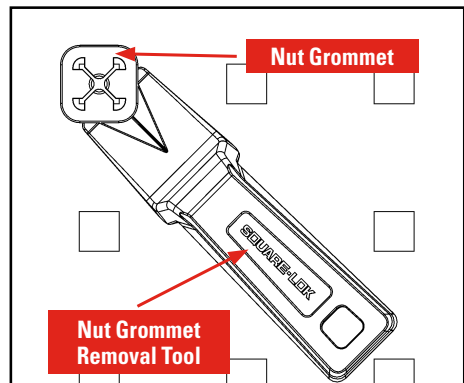
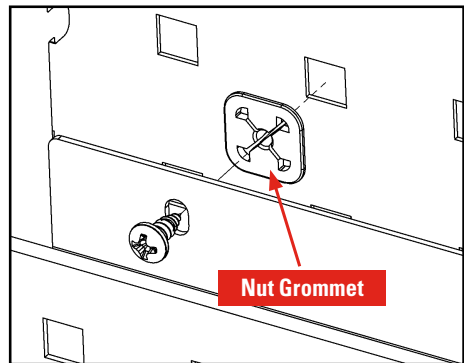

Installing Square-Lok™ Divider Wall

Mobilis Double Door (95071) and Double Door MAX (95072) safes include multiple shelf sections designed to be used with a divider wall.

1. Before installing the Divider Wall insert the neoprene floor mat onto the floor of the safe.
2. Determine which side of the safe you would like to install the divider wall. Based on your model of safe, four (4) nut grommets will need to be placed on the back wall, and two (2) or three (3) nut grommets on the side wall.
3. Install the nut grommets into the locations indicated on the diagram above. Count up from the floor and over from the back corner to each specified location.

NOTE: Start with the first full square hole as "1". Do not count the partial square hole directly in the corner.

Mobilis™ Safe Double Door – No. 95071

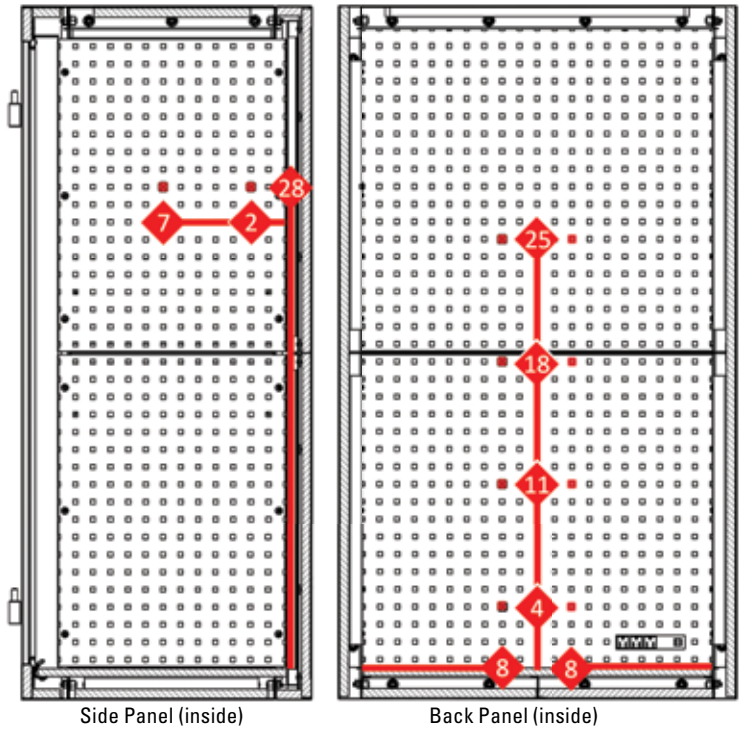

Side Panel (inside)

Back Panel (inside)

Mobilis™ Safe Double Door MAX – No. 95072

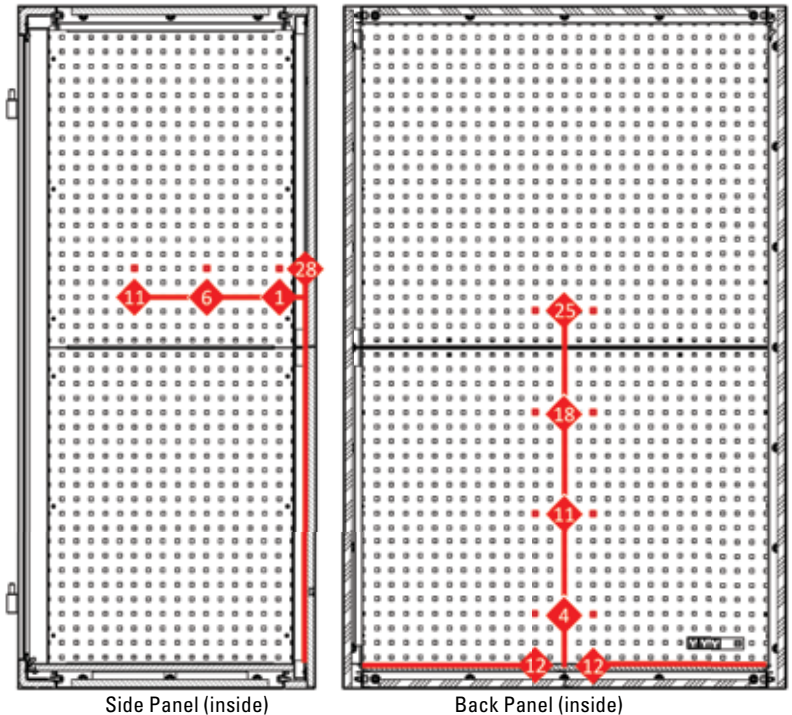

Side Panel (inside)

Back Panel (inside)

4. Depending on safe model, install two or three nut grommets into the one end of the divider cap.

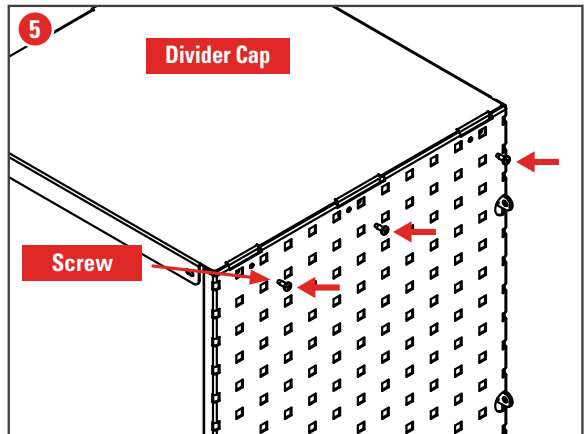
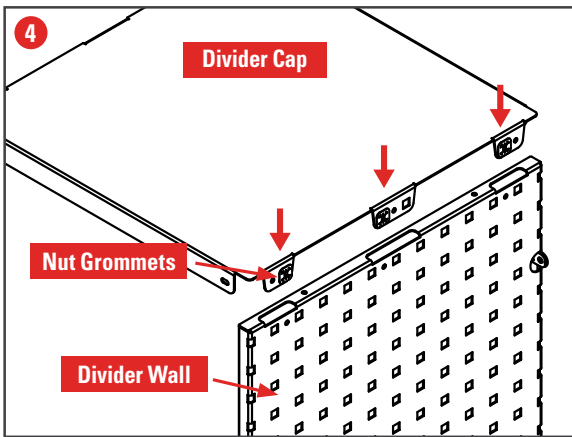

5. Place Divider Cap onto the top of the DividerWall and install the two or three screws through the Divider Wall and into each nut grommet installed into the Divider Cap.

6. Place assembly into safe and secure with a screw into each previously installed nut grommet in the back and side interior walls.

7. Shelves are composed of multiple shelf components to create either full or partial shelves. They can be placed anywhere under the Divider Cap between the Divider Wall and interior side wall."

To install shelf component place one end of shelf into wall, rotate up, and slide other side into opposite wall.

8. To increase the stability of the Divider Wall, a screw can be installed into the wood floor of the safe. To install, make sure Divider Wall is square to back wall and predrill a 1/16" hole and insert screw near the front of the Divider Wall.

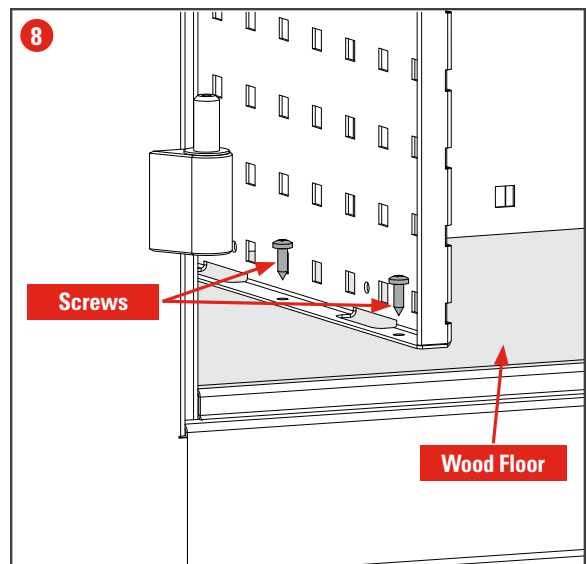
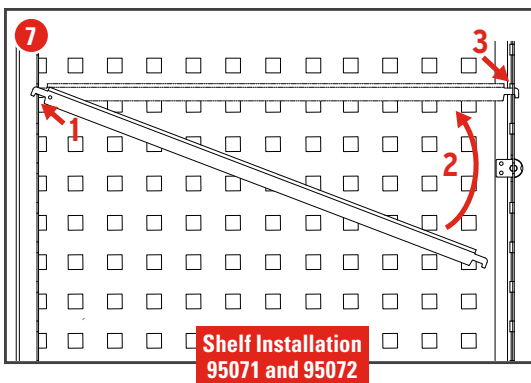
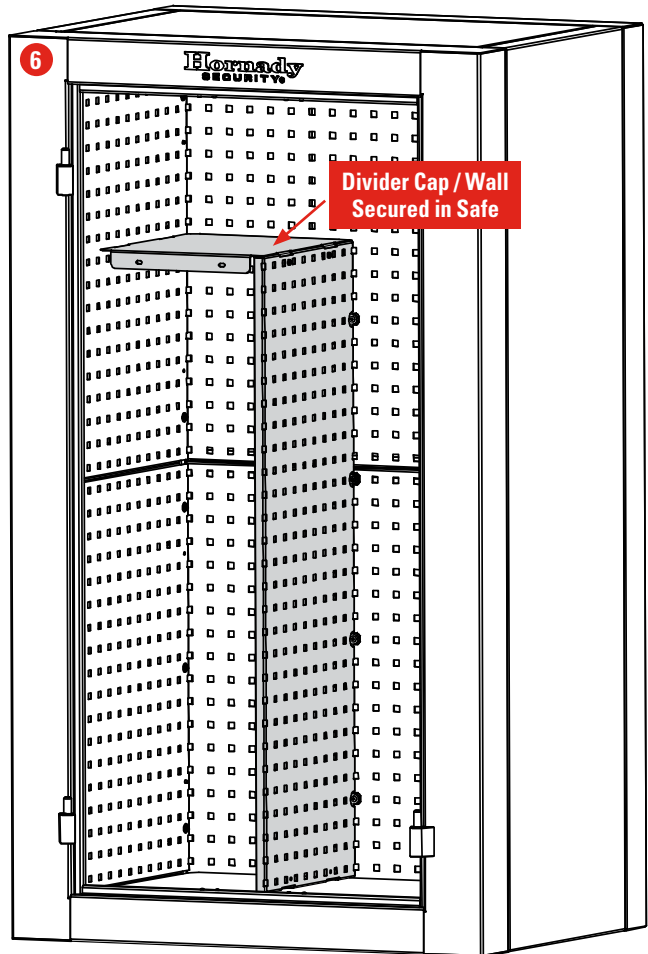

Assemble the Divider Wall with the Divider Support

The Divider Wall can be placed anywhere along the back wall to create more space for long gun storage.

1. Before installing the Divider Wall insert the neoprene floor mat onto the floor of the safe.
2. To install, place nut grommets in the back wall corresponding with the mounting tabs in the Divider Wall. Secure Divider Wall to back wall by installing screws into Nut Grommets.
3. Place the Divider Support on top of the Divider Wall and insert Nut Grommets into Divider Wall and back wall corresponding to the holes in the Divider Support.
4. To increase the stability of the Divider Wall, a screw should be installed into the wood floor of the safe. To install, make sure Divider Wall is square to back wall and predrill a 1/16" hole and insert screw near the front of the Divider Wall.
(See image 8 on previous page.)

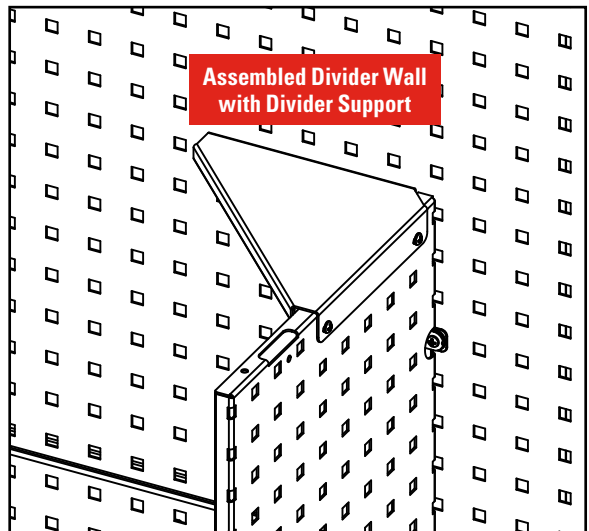
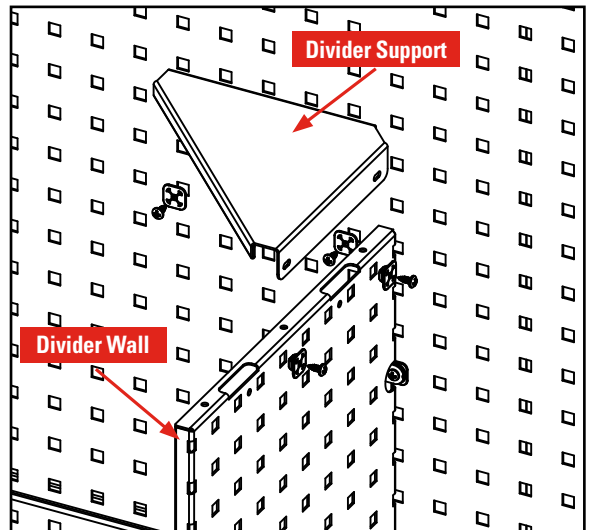

Installing Square-Lok™ Shelves

No. 95780

Mobilis Safe (95070) includes three 9" x 9" shelves that can be installed anywhere inside the safe.

Installation:

Place top hooks into the holes in the Square-Lok™ panel, rotate the shelf down so the bottom hooks also enter a hole, and then slide the shelf down to lock into place.

Removal:

Lift the shelf vertically, rotate the bottom hooks out of the holes in the wall panel, and then slide top hooks out.

Mobilis Safe 95071 and 95072 include multiple shelf sections designed to be used with a divider wall.

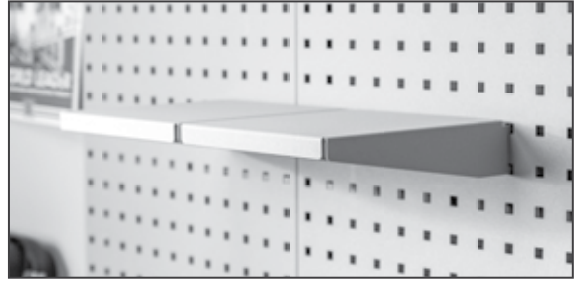

Installing Square-Lok™ Gun Rack

These patent pending, dual-purpose gun racks are designed to maximize space and organize your safe. They provide a notch for long gun barrels to rest, but also a loop to hold most handguns vertically between barrels.

To install gun racks:

Place top hooks into the holes of the Square-Lok™ wall panel, rotate the gun rack down so the bottom hooks also enter a hole, and then slide the gun rack down to lock into place.

To remove gun racks:

Lift the gun rack vertically and rotate the bottom hooks out of the holes in the Square-Lok™ wall panel, then slide top hooks out.

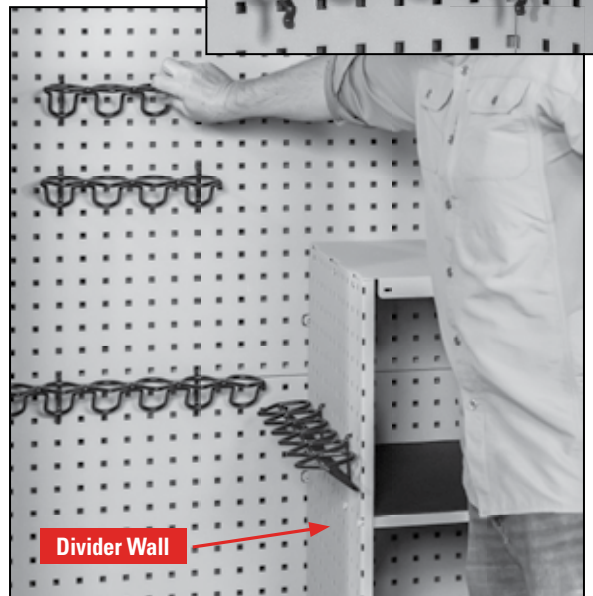

NOTE: Gun racks and other Square-Lok™ accessories can be installed on the Divider Wall.

CARE AND MAINTENANCE

With a little care and maintenance, your Mobilis™ Safe will last a lifetime. Keep the door hinge pins lightly greased so that the door opens smoothly. Vacuum the inside from time to time, and wipe down the outside with a soft cloth and mild detergent. Never use harsh solvents or abrasives on any surfaces, as they may damage the exterior finish or interior materials

FREQUENTLY ASKED QUESTIONS

I've lost my keys. Can I get a replacement?

Contact Hornady Security at 800-338-3220 and one of our Customer Service Representatives will assist you.

Where can I find the serial number?

The serial number is located on the back of the safe. Prior to mounting the safe, record the serial number for future reference.

How long should the batteries last?

Quality batteries should last approximately 12 months, depending on use.

Additional information and videos can be found at HornadySecurity.com or call 1-800-338-3220.

Mobilis™ Safe Limited Warranty

Hornady Security® warrants the Mobilis™ Safe will, in normal use and service, be free from defects in workmanship or materials for one (1) year from date of purchase.

This Limited Warranty does not cover any of the following:

- (a) Damage, deterioration, or malfunction resulting from accident, negligence, misuse, improper installation, or lack of maintenance;
- (b) Any defects not discovered and reported to Hornady Security® during the one (1) year warranty period;
- (c) Usual and customary deterioration or wear resulting from normal use.

This Limited Warranty is not transferable and is enforceable by the original owner only. In the event that Hornady Security® receives notice from the original purchase of a warranty claim in conformity herewith, Hornady Security® will promptly undertake an investigation of such claim. If the warranty claim is covered by the Limited Warranty, Hornady Security® will, in its sole discretion, repair the defect(s) or replace Mobilis™ Safe at the expense of Hornady Security®.

Disclaimer of Implied Warranties. EXCEPT AS IS OTHERWISE EXPRESSLY SET FORTH IN THE ABOVE LIMITED WARRANTY, HORNADY SECURITY® MAKES NO OTHER REPRESENTATIONS OR WARRANTIES OF ANY KIND, WHETHER EXPRESSED OR IMPLIED, BY OPERATION OF LAW OR OTHERWISE WITH RESPECT TO THE MOBILIS™ SAFE OR ANY COMPONENT PART THEREOF, INCLUDING WITHOUT LIMITATION ANY REPRESENTATION OR WARRANTY WITH RESPECT TO MERCHANTABILITY OR FITNESS FOR ANY PARTICULAR PURPOSE OR USE.

Limitation on Liability. THE OBLIGATION OF HORNADY SECURITY® TO REPAIR OR REPLACE AS PROVIDED ABOVE SHALL BE THE SOLE AND ONLY REMEDY RESPECTING ANY DEFECT IN THE MOBILIS™ SAFE, OR ANY COMPONENT PART THEREOF. IN THE EVENT THAT THE FOREGOING REMEDY FAILS OF ITS ESSENTIAL PURPOSE, THE LIABILITY OF HORNADY SECURITY® TO PURCHASER SHALL NOT, IN ANY EVENT, EXCEED THE ACTUAL PURCHASE PRICE OF THE NON-CONFORMING GOODS; AND

Limitation on the Nature of Damages. HORNADY SECURITY® SHALL NOT, UNDER ANY CIRCUMSTANCES, BE LIABLE TO THE PURCHASER OR ANY THIRD PARTY FOR ANY SPECIAL, INDIRECT, INCIDENTAL, CONSEQUENTIAL, LIQUIDATED OR PUNITIVE DAMAGES OF ANY NAME, NATURE OR DESCRIPTION. HORNADY SECURITY® IS NOT RESPONSIBLE FOR DAMAGE TO OR THEFT OF THE MOBILIS™ SAFE, OR ITS CONTENTS.

Product Registration and Service

You must register your product to obtain Warranty Service. Complete the registration form at hornady.com/warranties.

To Receive Warranty Service

To report a warranty claim, call Hornady® at 800-338-3220 to request a return authorization number. Returns will not be accepted without prior return authorization by Hornady®.

Post-Warranty Service Information

For issues concerning service after the Limited Warranty expires, contact Hornady® at 800-338-3220.

Product Serial Number and Reference Information

You must register your product in order to obtain warranty service. In the event you should need service for your product, please note the following information:

Serial Number _____
(See the back or bottom of safe)

Key Number _____
(See the face of the lock)

Date Purchased _____ Retailer _____



Hornady Manufacturing Company
P.O. Box 1848, Grand Island, Nebraska 68802-1848
hornady.com/contact